

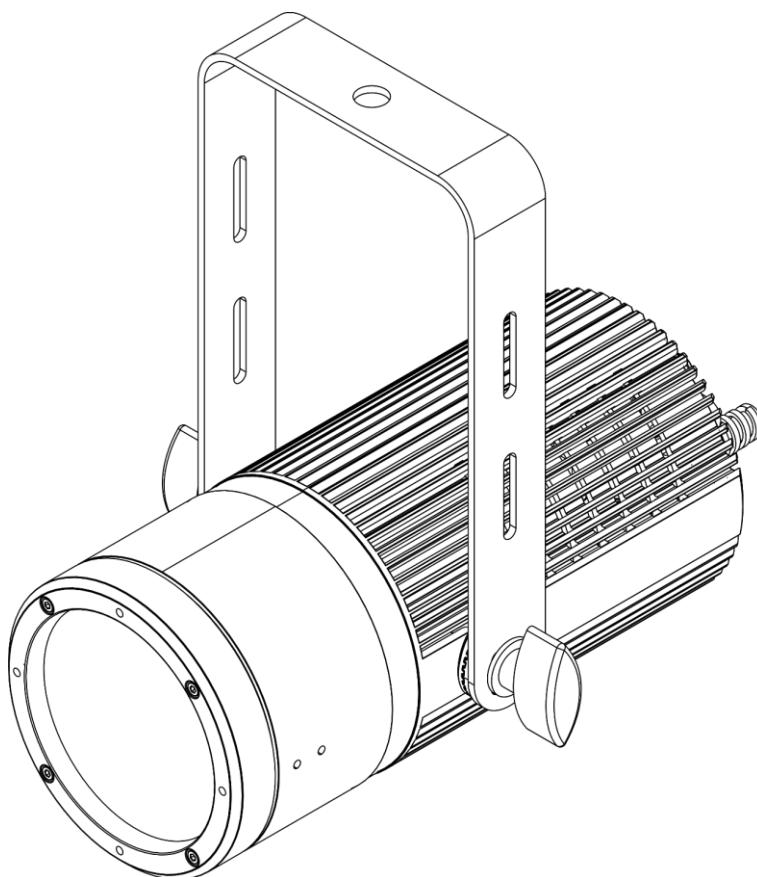

USER MANUAL



ENGLISH

Performer Pendant 75 Q6 V1

Product code: 33149

Preface

Thank you for purchasing this Showtec product.

The purpose of this user manual is to provide instructions for the correct and safe use of this product.

Keep the user manual for future reference as it is an integral part of the product. The user manual shall be stored at an easily accessible location.

This user manual contains information concerning:

- Safety instructions
- Intended and non-intended use of the product
- Installation and operation of the product
- Maintenance procedures
- Troubleshooting
- Transport, storage and disposal of the product

Non-observance of the instructions in this user manual may result in serious injuries and damage of property.

©2022 Showtec. All rights reserved.

No part of this document may be copied, published or otherwise reproduced without the prior written consent of Highlite International.

Design and product specifications are subject to change without prior notice.

For the latest version of this document or other language versions, please visit our website www.highlite.com or contact us at service@highlite.com.

Highlite International and its authorized service providers are not liable for any injury, damage, direct or indirect loss, consequential or economic loss or any other loss arising from the use of, or inability to use or reliance on the information contained in this document.

Table of contents

1. Introduction.....	4
1.1. Before Using the Product	4
1.2. Intended Use	4
1.3. Product Lifespan	4
1.4. LEDs Lifespan	4
1.5. Text Conventions.....	4
1.6. Symbols and Signal Words	5
1.7. Symbols on the Information Label	5
2. Safety	6
2.1. Warnings and Safety Instructions	6
2.2. Requirements for the User	8
3. Description of the Device	9
3.1. Front View	9
3.2. Back View	10
3.3. Product Specifications	11
3.4. Dimensions	12
3.5. Optional Accessories.....	13
4. Installation	13
4.1. Safety Instructions for Installation	13
4.2. Personal Protective Equipment	13
4.3. Installation Site Requirements	13
4.4. Rigging	14
4.4.1. Angle Adjustment.....	15
4.5. Connecting to Power Supply	16
4.6. Power Linking of Multiple Devices.....	17
5. Setup	18
5.1. Warnings and Precautions.....	18
5.2. DMX Connection	18
5.2.1. DMX-512 Protocol	18
5.2.2. DMX Cables.....	18
5.2.3. DMX Linking	19
5.2.4. DMX Addressing.....	20
6. Operation	21
6.1. Safety Instructions for Operation	21
6.2. Control Modes.....	21
6.2.1. Wireless DMX	21
6.3. DMX Channels.....	22
6.3.1. HSIC (7 CH)	22
6.3.2. SSP (8 CH), TOUR (13 CH), TR16 (20 CH)	23
6.3.3. CMY (8 CH).....	25
6.4. RDM Information	27
6.4.1. RDM Details	27
6.4.2. Supported RDM PIDs for the Device.....	28
7. Troubleshooting	29
8. Maintenance	30
8.1. Safety Instructions for Maintenance	30
8.2. Preventive Maintenance	30
8.2.1. Basic Cleaning Instructions	30
8.3. Corrective Maintenance	31
8.3.1. Replacing the Fuse.....	31
9. Deinstallation, Transportation and Storage	31
9.1. Instructions for Deinstallation	31

9.2. Instructions for Transportation31

9.3. Storage31

10. Disposal32

11. Approval.....32

1. Introduction

1.1. Before Using the Product



Important

Read and follow the instructions in this user manual before installing, operating or servicing this product.

The manufacturer will not accept liability for any resulting damages caused by the non-observance of this manual.

After unpacking, check the contents of the box. If any parts are missing or damaged, contact your Highlite International dealer.

Your shipment includes:

- Showtec Performer Pendant 75 Q6
- 1 x safety cable
- Power cable with open-end power cable (1,25 m)
- User manual

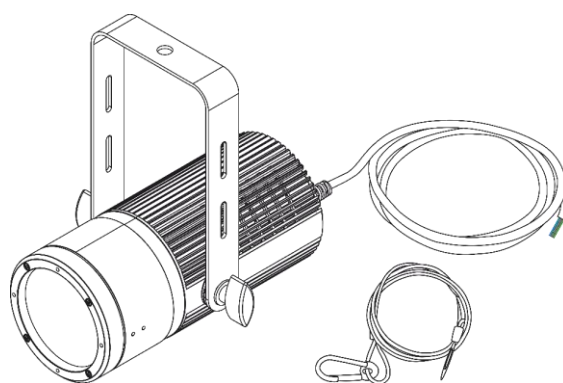

Fig. 01

1.2. Intended Use

This device is intended for professional use as a theater spot and is suitable for fixed indoor installation only. This device is not suitable for households and for general lighting.

Any other use, not mentioned under intended use, is regarded as non-intended and incorrect use.

1.3. Product Lifespan

This device is not designed for permanent operation. Disconnect the device from the electrical power supply when the device is not in operation. This will reduce the wear and will improve the device's lifespan.

1.4. LEDs Lifespan

The light output of the LEDs gradually decreases over time (lumen depreciation). High operating temperatures contribute to this process. You can extend the lifespan of the LEDs by providing adequate ventilation and operating the LEDs at the lowest possible brightness.

1.5. Text Conventions

Throughout the user manual the following text conventions are used:

- Buttons: All buttons are in bold lettering, for example "Press the **UP/DOWN** buttons"
- References: References to chapters and parts of the device are in bold lettering, for example: "Refer to **2. Safety**", "turn the **adjustment handle (05)**"
- 0–255: Defines a range of values
- Notes: **Note:** (in bold lettering) is followed by useful information or tips

1.6. Symbols and Signal Words

Safety notes and warnings are indicated throughout the user manual by safety signs.

Always follow the instructions provided in this user manual.



DANGER

Indicates an imminently hazardous situation which, if not avoided, will result in death or serious injury.



WARNING

Indicates a potentially hazardous situation which, if not avoided, could result in death or serious injury.



CAUTION

Indicates a potentially hazardous situation, which, if not avoided, may result in minor or moderate injury.



Attention

Indicates important information for the correct operation and use of the product.



Important

Read and observe the instructions in this document.



Electrical hazard



Provides important information about the disposal of this product.

1.7. Symbols on the Information Label

This product is provided with an information label. The information label is located on the mounting bracket.

The information label contains the following symbols:



This device is designed for indoor use.



This device falls under IEC protection class I.



This device shall not be treated as household waste.

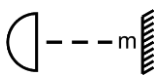

Minimum distance from lighted objects.



Caution: Risk of electric shock. Do not open.
Caution: To reduce the risk of electric shock, do not remove cover. No user-serviceable parts inside. Refer servicing to qualified personnel.

2. Safety



Important

Read and follow the instructions in this user manual before installing, operating or servicing this product.

The manufacturer will not accept liability for any resulting damages caused by the non-observance of this manual.

2.1. Warnings and Safety Instructions



DANGER

Danger for children

For adult use only. The device must be installed beyond the reach of children.

- Do not leave various parts of the packaging (plastic bags, polystyrene foam, nails, etc.) within children's reach. Packaging material is a potential source of danger for children.



DANGER

Electric shock caused by dangerous voltage inside

There are areas within the device where dangerous touch voltage ($> 120 \text{ V DC}$) may be present.

- Do not open the device or remove any covers.
- Do not operate the device if the covers or the housing are open. Before operation, check if the housing is firmly closed and all screws are tightly fastened.
- Disconnect the device from electrical power supply before service and maintenance, and when the device is not in use.



DANGER

Electric shock caused by short-circuit

This device falls under IEC protection class I.

- Make sure that the device is electrically connected to ground (earth). Connect the device only to a socket-outlet with ground (earth) connection.
- Do not cover the ground (earth) connection.
- Do not bypass the thermostatic switch or fuses.
- Do not let the power cable come into contact with other cables. Handle the power cable and all connections with the mains with caution.
- Do not modify, bend, mechanically strain, put pressure on, pull or heat up the power cable.
- Make sure that the power cable is not crimped or damaged. Examine the power cable periodically for any defects.
- Do not immerse the device in water or other liquids. Do not install the device in a location where flooding may occur.
- Do not use the device during thunderstorms. Disconnect the device from the electrical power supply immediately.

**WARNING**
Risk of burns due to hot surface

The surface and the inner parts of the device can become very hot during operation.

- Do not touch the device during operation.
- Allow the device to cool down for at least 15 minutes before handling.

**WARNING**
Risk of epileptic shock

Strobe lighting can trigger seizures in photosensitive epilepsy. Sensitive persons should avoid looking at strobe lights.

**WARNING**
Possible eye damage caused by high light intensity

Possibly hazardous optical radiation emitted from this device.

- Do not look at the operating light source. May be harmful to the eye.
- Do not look at the light source with optical instruments that may concentrate the light output.
- Make sure that persons are not looking directly into the light source when the device lights up suddenly. This can happen when the device is powered or when it receives DMX signal, or when certain menu items are selected.
- Disconnect power supply before servicing.
- Wear protective goggles if looking into light source during service or maintenance.

**Attention**
Power supply

- Before connecting the device to the power supply, make sure that the current, voltage and frequency match the input voltage, current and frequency specified on the information label on the device.
- Make sure that the cross-sectional area of the extension cords and power cables is sufficient for the required power consumption of the device.

**Attention**
General safety

- Do not insert objects into the air vents.
- Do not connect the device to a dimmer pack.
- Do not switch the device on and off in short intervals. This decreases the device's life.
- Do not shake the device. Avoid brute force when installing or operating the device.
- Change the lens or the LEDs if they are visibly damaged to such an extent that their effectiveness is impaired, for example by cracks or deep scratches. Contact your Highlite International dealer for more information, as servicing can be performed only by instructed or skilled persons.
- If the device is dropped or struck, disconnect the device from the electrical power supply immediately.

- If the device is exposed to extreme temperature variations (e.g. after transportation), do not switch it on immediately. Let the device reach room temperature before switching it on, otherwise it may be damaged by the formed condensation.
- If the device fails to work properly, discontinue the use immediately.



Attention
For professional use only
This device shall be used only for the purposes it is designed for.

This device is intended for professional use as a theater spot. Any incorrect use may lead to hazardous situations and result in injuries and material damage.

- This device is not suitable for households and for general lighting.
- This device is not designed for permanent operation.
- This device does not contain user-serviceable parts. Unauthorized modifications to the device will render the warranty void. Such modifications may result in injuries and material damage.



Attention
Before each use, examine the device visually for any defects.

Make sure that:

- All screws used for installing the device or parts of the device are tightly fastened and are not corroded.
- The safety devices are not damaged.
- There are no deformations on housings, fixations and installation points.
- The lens is not cracked or damaged.
- The power cables are not damaged and do not show any material fatigue.



Attention
Do not expose the device to conditions that exceed the rated IP class conditions.

This device is IP20 rated. IP (Ingress Protection) 20 class provides protection against solid objects greater than 12 mm, such as fingers, and no protection against harmful ingress of water.

Keep the connectors sealed with the rubber caps when the connectors are not in use.

2.2. Requirements for the User

This product may be used by ordinary persons. Maintenance may be carried by ordinary persons. Installation and service shall be carried out only by instructed or skilled persons. Contact your Highlite International dealer for more information.

Instructed persons have been instructed and trained by a skilled person, or are supervised by a skilled person, for specific tasks and work activities associated with the installation, service and maintenance of this product, so that they can identify risks and take precautions to avoid them.

Skilled persons have training or experience, which enables them to recognize risks and to avoid hazards associated with the installation, service and maintenance of this product.

Ordinary persons are all persons other than instructed persons and skilled persons. Ordinary persons include not only users of the product but also any other persons that may have access to the device or who may be in the vicinity of the device.

3. Description of the Device

The Showtec Performer Pendant 75 Q6 is a 70 watt RGBALC LED Fresnel. It is a fixed installation lamp (House Light) that works perfectly with show light to create an optimal atmosphere. Its 6-colour LED engine (red, green, blue, amber, lime, cyan) has 48 preset colours and provides highly accurate colour temperatures. It has a CRI of no less than 92. In addition, it has silent operations and 4 available dimming curves with a range of 0–100 %.

3.1. Front View

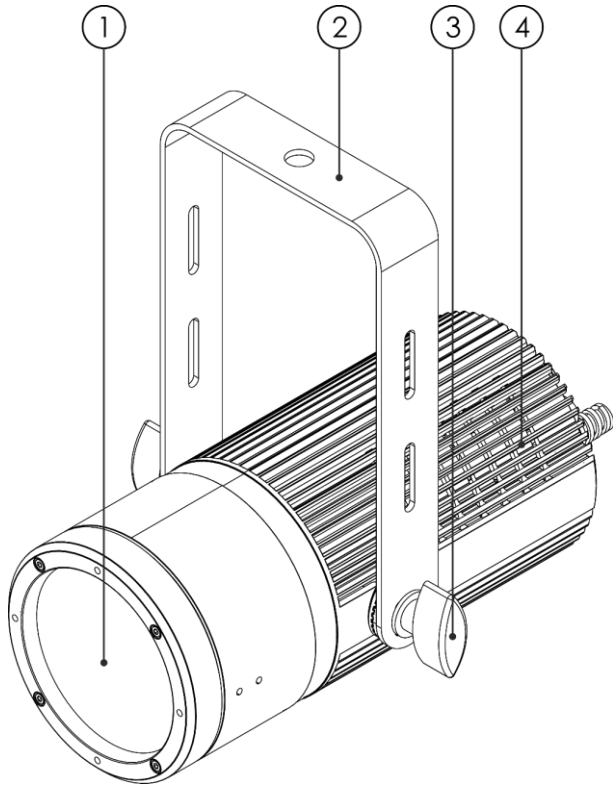

Fig. 02

- 01) Lens
- 02) Mounting bracket
- 03) Adjustment screw
- 04) Ventilation openings

3.2. Back View

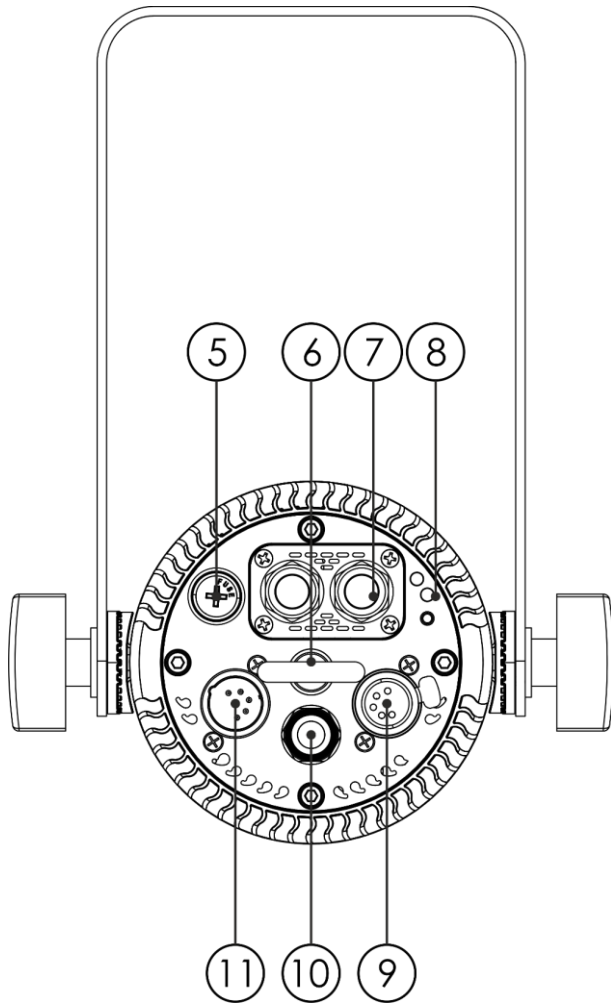

Fig. 03

- 05) Fuse T3,15 A, 250 V
- 06) Safety eye
- 07) Phoenix connectors IN / OUT
- 08) Link button (Red + Green LED)
- 09) 5-pin DMX signal connector OUT
- 10) Powercable 100-240 V AC, 50/60 Hz
- 11) 5-pin DMX signal connector IN

3.3. Product Specifications

Model:	Performer Pendant 75 Q6
--------	-------------------------

Electrical:	
Input voltage:	100–240 V AC, 50/60 Hz
Power consumption:	70 W
Fuse:	F3,15A, 250 V

Physical:	
Dimensions:	332 x 192 x 115 mm (L x W x H)
Weight:	3,4 kg

Optics:	
Light source:	1 x 80 W RGBALC LED
Dimmer:	0–100 %
Dimmer resolution:	16-bit
Strobe:	0–25 Hz
Beam angle:	30°
Field Angle Circular	30°
Total lumen:	2684 lm
Lumen Red:	305 lm
Lumen Green:	527 lm
Lumen Blue:	119 lm
Lumen Amber:	462 lm
Lumen Lime:	1034 lm
Lumen Cyan:	207 lm
CRI:	92
CCT:	1800–10000 K
Refresh rate:	1200–25000 Hz

Operation and control:	
Control:	DMX-512, W-DMX, RDM
DMX channels:	7, 8, 8, 13, 20 channels

Connections:	
Power connections:	Open end power cable
Data connections:	5-pin DMX connectors IN/OUT Phoenix connectors IN/OUT
Signal pin OUT:	Pin 1 (ground), pin 2 (-), pin 3 (+), pin 4 (N/C), pin 5 (N/C)

Construction:	
Housing:	Aluminum
Color:	Black
IP rating:	IP20
Cooling:	Convection / Axial Fan

Thermal:	
Maximum ambient temperature t_a :	45 °C
Minimum ambient temperature:	0 °C

Minimum distance:	
Minimum distance from flammable surfaces:	0,5 m
Minimum distance to lighted object:	0,8 m

3.4. Dimensions

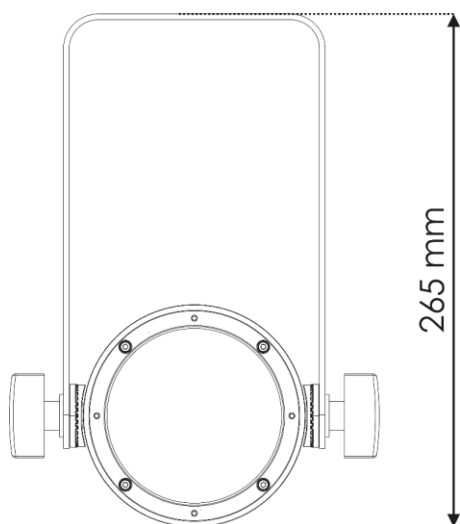

Fig. 04

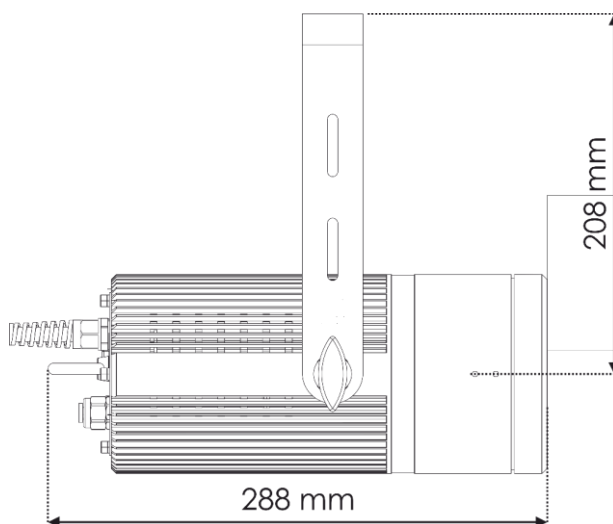

Fig. 05

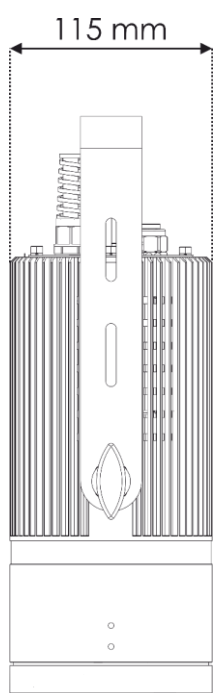

Fig. 06

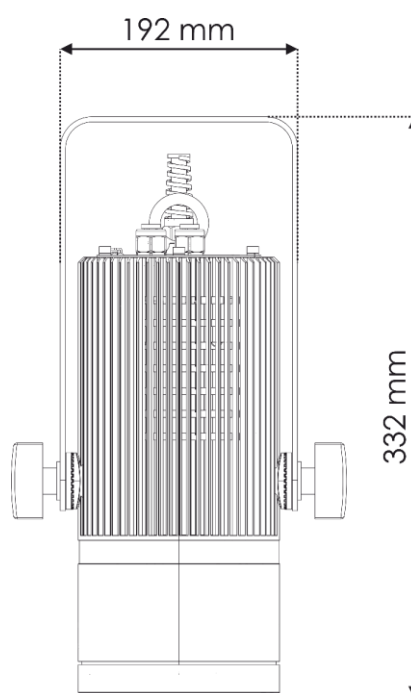

Fig. 07

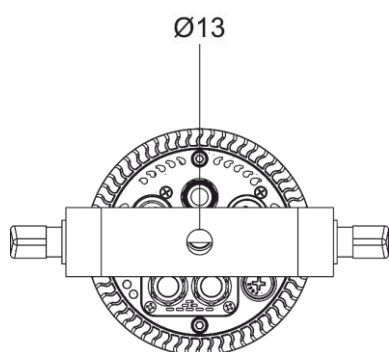

Fig. 08

3.5. Optional Accessories

You have to additionally purchase the following accessory:

[50409](#) (RDM Touch DMX Tester: for setting the DMX modes)

4. Installation

4.1. Safety Instructions for Installation



WARNING

Incorrect installation can cause serious injuries and damage of property.

If trussing systems are used, installation must be carried out only by instructed or skilled persons.

Follow all applicable European, national and local safety regulations concerning rigging and trussing.

4.2. Personal Protective Equipment

During installation and rigging wear personal protective equipment in compliance with the national and site-specific regulations.

4.3. Installation Site Requirements

- The device can be used indoors only.
- The device can be mounted to a truss or another rigging structure in any orientation.
- The minimum distance between the light output and the illuminated surface must be bigger than 0,8 m.
- The minimum distance to other objects must be bigger than 0,5 m.
- The maximum ambient temperature $t_a = 45\text{ °C}$ must never be exceeded.
- The relative humidity must not exceed 50 % with an ambient temperature of 45 °C.

4.4. Rigging

The device can be mounted to a truss or other rigging structure in any orientation, as shown in Fig. 09. Make sure that all loads are within the pre-determined limits of the supporting structure.



CAUTION

Restrict the access under the work area during rigging and/or derigging.

To mount the device, follow the steps below:

- 01) Use a clamp to attach the device to the supporting structure, as shown in Fig. 09. Make sure that the device cannot move freely.
- 02) Secure the device with a secondary suspension, for example a safety cable. Make sure that the secondary suspension can hold 10 times the weight of the device. If possible, the secondary suspension should be attached to a supporting structure independent of the primary suspension. Put the safety cable through the **safety eye (06)**, as shown in Fig. 09. You can use the safety cable supplied with the device.

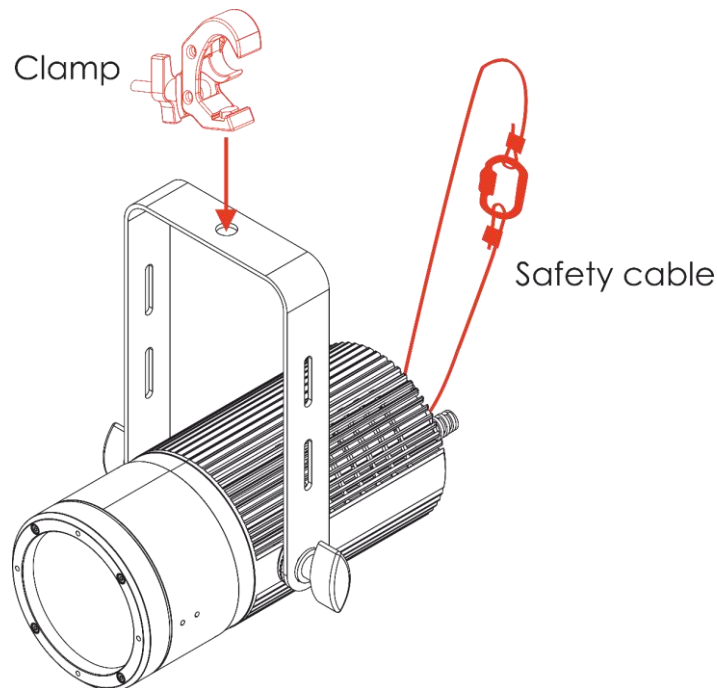

Fig. 09

4.4.1. Angle Adjustment

You can adjust the angle of the device with the 2 **adjustment screws (03)**.

- 01) Turn the **adjustment screws (03)** counterclockwise to release them.
- 02) Tilt the device at the desired angle (see Fig. 10).
- 03) Turn the **adjustment screws (03)** clockwise to tighten them. Make sure that the device cannot move freely after the **adjustment screws (03)** are tightened.

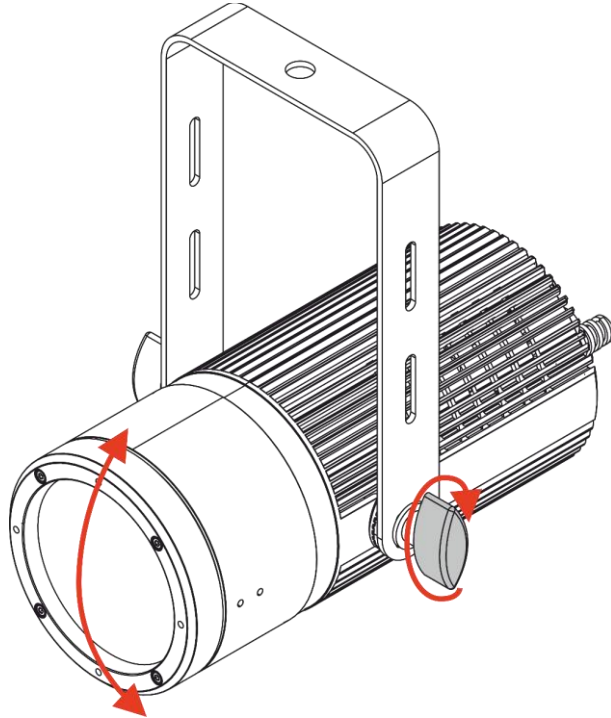

Fig. 10

4.5. Connecting to Power Supply



DANGER
Electric shock caused by short-circuit

The device is supplied with a power cord without a plug. The device is suitable for direct connection to the mains supply. Connection of the device to the mains supply must be carried out only by skilled or instructed persons.

The device accepts AC mains power at 100–240 V and 50/60 Hz. Do not supply mains power at any other voltage or frequency to the device.

This device falls under IEC protection class I. Make sure that the device is always electrically connected to the ground (earth).

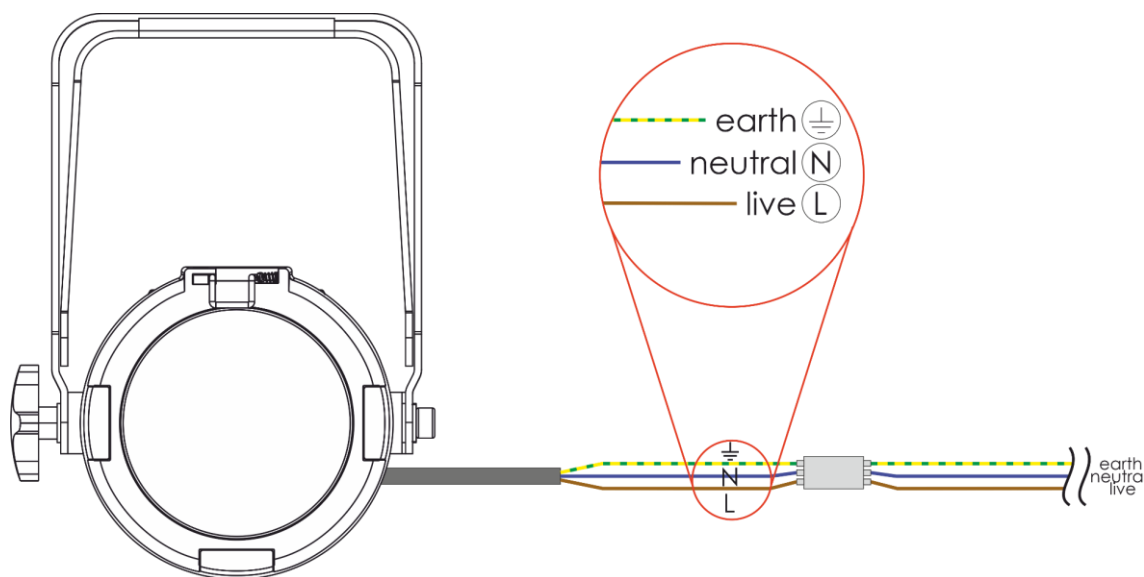

Fig. 11

- Before connecting the device to the mains supply, make sure that the power supply matches the input voltage specified on the information label on the device.
- Make sure that the conductors are connected correctly.
- Do not connect the device to a dimmer circuit, as this may damage the device.

4.6. Power Linking of Multiple Devices

This device supports power linking. Power can be relayed to another device via the power OUT connector. Note that the input and the output connectors have different designs: one type cannot be connected to the other.

Power linking of multiple devices must be carried out only by instructed or skilled persons.



WARNING

Incorrect power linking may lead to overload of the electrical circuit and result in serious injuries and damage of property.

To prevent overload of the electrical circuit, when power linking multiple devices:

- Use cables with sufficient current-carrying capacity. The power cable supplied with the device is not suitable for power linking of multiple devices.
- Make sure that the total current draw of the device and all connected devices does not exceed the rated capacity of the power cables and the circuit breaker.
- Do not link more devices on one power link than the maximum recommended number.

Maximum recommended number of devices:

- at 100–120 V: 12 devices Performer Pendant 75 Q6
- at 200–240 V: 25 devices Performer Pendant 75 Q6

5. Setup

5.1. Warnings and Precautions



DANGER
Electric shock caused by short-circuit



Attention
Connect all data cables before supplying power.
Disconnect power supply before connecting or disconnecting data cables.

5.2. DMX Connection

5.2.1. DMX-512 Protocol

You need a DMX serial data link to run light shows of one or more devices using a DMX-512 controller or to run synchronized shows of two or more devices set in a master/slave operating mode.

The Performer Pendant 75 Q6 has 5-pin DMX signal IN and OUT connectors.

The pin assignment is as follows:

- 5-pin: pin 1 (ground), pin 2 (-), pin 3 (+), pin 4 (N/C), pin 5 (N/C)

Devices on a serial data link must be daisy-chained in a single line. The number of devices that you can control on one data link is limited by the combined number of the DMX channels of the connected devices and the 512 channels available in one DMX universe.

To comply with the TIA-485 standard, no more than 32 devices should be connected on one data link. In order to connect more than 32 devices on one data link, you must use a DMX optically isolated splitter/booster, otherwise this may result in deterioration of the DMX signal.

Note:

- Maximum recommended DMX data link distance: 300 m
- Maximum recommended number of devices on a DMX data link: 32 devices

5.2.2. DMX Cables

Shielded twisted-pair cables with 5-pin XLR connectors must be used for reliable DMX connection. You can purchase DMX cables directly from your Highlite International dealer or make your own cables.

If you use 3-pin XLR audio cables for DMX data transmission, this may lead to signal degradation and unreliable operation of the DMX network.

When you make your own DMX cables, make sure that you connect the pins and wires correctly as shown in Fig. 12.

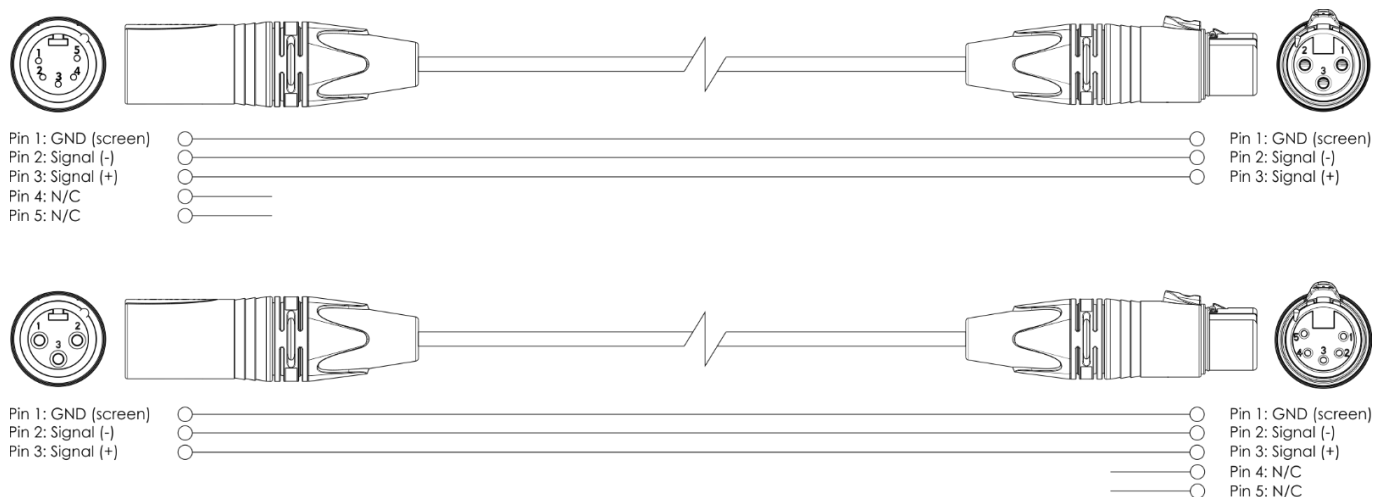

Fig. 12

5.2.3. DMX Linking

To connect multiple devices on one DMX data link, follow the steps below:

- 01) Use a 5-pin DMX cable to connect the DMX OUT connector of the lighting controller to the DMX IN connector of the first device.
- 02) Connect the first device's DMX OUT connector to the second device's DMX IN connector with a 5-pin DMX cable.
- 03) Repeat step 2 to connect all devices in a daisy-chain as shown in Fig. 13.
- 04) Connect a DMX terminator (120 Ω resistor) to the DMX OUT connector of the last device on the data link.

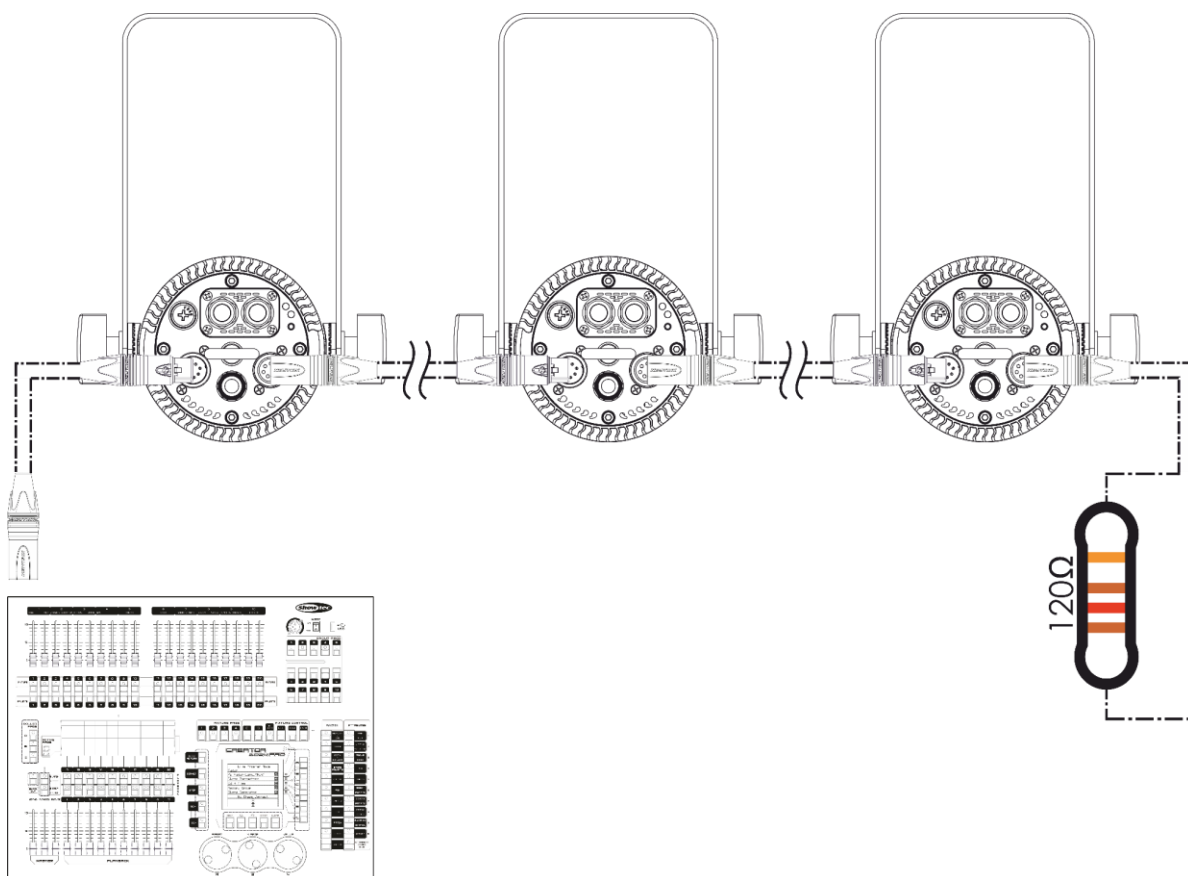

Fig. 13

5.2.4. DMX Addressing

In a setup with multiple devices, make sure that you set the DMX starting address of each device correctly. The Performer Pendant 75 Q6 has 5 personalities: 7 channels, 8 channels, 8 channels, 13 channels and 20 channels.

If you want to connect multiple devices on one data link and use them in 20-channel mode, for example, follow the steps below:

- 01) Set the starting address of the 1st device on the data link to 1 (001).
- 02) Set the starting address of the 2nd device on the data link to 21 (021), as $1 + 20 = 21$.
- 03) Set the starting address of the 3rd device on the data link to 41 (041) as $21 + 20 = 41$.
- 04) Continue assigning the starting addresses of the remaining devices by adding each time 20 to the previous number.

Make sure that you do not have any overlapping channels in order to control each Performer Pendant 75 Q6 correctly. If two or more devices are addressed similarly, they will work similarly.

6. Operation

6.1. Safety Instructions for Operation



Attention

This device must be used only for the purposes it is designed for.

This device is intended for professional use as a theater spot. This device is not suitable for households and for general lighting.

Any other use, not mentioned under intended use, is regarded as non-intended and incorrect use.



Attention

Power supply

Before connecting the device to the power supply, make sure that the current, voltage and frequency match the input voltage, current and frequency specified on the information label on the device.

6.2. Control Modes

The Performer Pendant 75 Q6 can only be operated with a special RDM controller (example 50409).

The Performer Pendant 75 Q6 supports the following control modes:

- DMX-512, RDM 7, 8, 8, 13, 20 channels

To operate the device with a RDM controller:

- 01) See the manual of the RDM Touch DMX Tester (50409, chapter 10. RDM Controller on page 15–16)
- 02) Set the DMX starting address of the device in the Address menu of the RDM Touch.
- 03) Select the DMX channel mode in the RDM Touch.

6.2.1. Wireless DMX

To operate the device with wireless DMX:

Press and hold down the **link button (08)** for 10 seconds to connect the device to wireless DMX.

Wireless Indicator Light	Description
Red light on, Green light flashing slowly	Receiving DMX input from wireless DMX transmitter
Red light off, Green light flashing slowly	Waiting for wireless connection
Red light flashing slowly, Green light flashing slowly	Connected to wireless DMX transmitter but not receiving signal
Red light flashing quickly, Green light flashing slowly	Search wireless DMX signal

6.3. DMX Channels

6.3.1. HSIC (7 CH)

7 CH (HSIC)	Function	Value	Setting
1	Intensity	000–255	From low to high intensity (0–100 %)
2	Hue	000–255	From low to high intensity (0–100 %)
3	Hue Fine	000–255	From low to high intensity (0–100 %)
4	Saturation	000–255	From low to high intensity (0–100 %)
5	CCT	000–009	No function
		010	1800 K
		011–025	2200 K
		026–040	2700 K
		041–055	3000 K
		056–070	3200 K
		071–085	4000 K
		086–100	4500 K
		101–115	5000 K
		116–130	5600 K
		131–145	6000 K
		146–160	6500 K
		161–175	7000 K
		176–190	8000 K
		191–205	10000 K
		206–255	10000 K
6	Strobe	000–009	No function
		010–099	Strobe, from low to high frequency (0–25 Hz)
		100–109	No function
		110–179	Lightning strobe, from low to high frequency (0–25 Hz)
		180–189	No function
		190–255	Random strobe, from low to high frequency (0–25 Hz)
7	Control Mode	000–010	No Function
		011–100	Reserved
		101–110	Dimmer Off
		111–120	Dimmer Mode 4
		121–150	Reserved
		151–160	1200 Hz
		161–170	2400 Hz
		171–180	4000 Hz
		181–190	6000 Hz
		191–200	25000 Hz
		201–210	All Reset
		211–255	Reserved

6.3.2. SSP (8 CH), TOUR (13 CH), TR16 (20 CH)

8 CH (SSP)	13 CH (TOUR)	20 CH (TR16)	Function	Value	Setting
1	1	1	Master Dimmer	000-255	From low to high intensity (0-100 %)
		2	Dimmer Fine	000-255	From low to high intensity (0-100 %)
2	2	3	Red	000-255	From low to high intensity (0-100 %)
		4	Red Fine	000-255	From low to high intensity (0-100 %)
3	3	5	Green	000-255	From low to high intensity (0-100 %)
		6	Green Fine	000-255	From low to high intensity (0-100 %)
4	4	7	Blue	000-255	From low to high intensity (0-100 %)
		8	Blue Fine	000-255	From low to high intensity (0-100 %)
5	5	9	Amber	000-255	From low to high intensity (0-100 %)
		10	Amber Fine	000-255	From low to high intensity (0-100 %)
6	6	11	Lime	000-255	From low to high intensity (0-100 %)
		12	Lime Fine	000-255	From low to high intensity (0-100 %)
7	7	13	Cyan	000-255	From low to high intensity (0-100 %)
		14	Cyan Fine	000-255	From low to high intensity (0-100 %)
				000-010	No function
				011-015	Color 1 Loving Amber L176
				016-020	Color 2 Light Salmon R40
				021-025	Color 3 Scarlet L24
				026-030	Color 4 Flame Red L164
				031-035	Color 5 Easy White L747
				036-040	Color 6 Warm Peach R303
				041-045	Color 7 Dark Salmon L08
				046-050	Color 8 Sunset Red L25
				051-055	Color 9 Medium Bastard Amber L04
				056-060	Color 10 CID(To Tungsten) L237
				061-065	Color 11 Soft Golden Amber R321
				066-070	Color 12 Urban Sodium L652
				071-075	Color 13 LCT Yellow(Y1) L212
				076-080	Color 14 LEE Yellow L765
				081-085	Color 15 Ice And A Slice L513
				086-090	Color 16 Spring Yellow L100
				091-095	Color 17 LEE Plus Green L244
	8	15	Color Presets	096-100	Color 18 CalColor 30 Green R4430
				101-105	Color 19 Fern Green L122
				106-110	Color 20 Dark Yellow Green L90
				111-115	Color 21 LEE Fluorescent 3600 K L243
				116-120	Color 22 Turquoise R92
				121-125	Color 23 Kelly Green R94
				126-130	Color 24 Forest Green L327
				131-135	Color 25 Cosmetic Aqua Blue L191
				136-140	Color 26 Steel Green L728
				141-145	Color 27 Steel Blue L117
				146-150	Color 28 Special Steel Blue L354
				151-155	Color 29 Paler Lavender L53
				156-160	Color 30 New Colour Blue L501
				161-165	Color 31 Dark Steel Blue L174
				166-170	Color 32 Daylight Blue L165
				171-175	Color 33 Pale Lavender L136
				176-180	Color 34 Surprise Pink L194
				181-185	Color 35 Pale Violet L142
				186-190	Color 36 Perfect Lavender L700

8 CH (SSP)	13 CH (TOUR)	20 CH (TR16)	Function	Value	Setting
				191–195	Color 37 Light Pink L35
				196–200	Color 38 Pretty'n Pink L794
				201–205	Color 39 Follies Pink L328
				206–210	Color 40 Magical Magenta L795
				211–215	Color 41 Pale Rose L154
				216–220	Color 42 Smokey Pink L127
				221–225	Color 43 Flesh Pink L192
				226–230	Color 44 Special Rose Pink L332
				231–235	Color 45 Moroccan Pink L790
				236–240	Color 46 Pink L157
				241–245	Color 47 Cherry Rose R332
				246–250	Color 48 Cool LED Bright Pink L128
				251–255	No function
9	16	CCT		000–009	No function
				010	1800 K
				011–025	1800–2200 K
				026–040	2200–2700 K
				041–055	2700–3000 K
				056–070	3000–3200 K
				071–085	3200–4000 K
				086–100	4000–4500 K
				101–115	4500–5000 K
				116–130	5000–5600 K
				131–145	5600–6000 K
				146–160	6000–6500 K
				161–175	6500–7000 K
				176–190	7000–8000 K
10	17	Auto Programs		191–205	8000–10000 K
				206–255	10000 K
				000–040	No function
				041–050	Auto 1
				051–060	Auto 2
				061–070	Auto 3
				071–080	Auto 4
				081–090	Auto 5
				091–100	Auto 6
				101–110	Auto 7
				111–120	Auto 8
				121–130	Auto 9
				131–140	Auto 10
				141–150	Custom program 1
				151–160	Custom program 2
8	12	19	Strobe	161–255	No Function
				000–255	Program speed adjustment, from slow to fast
				000–009	No function
				010–099	Strobe, from low to high frequency (0–25 Hz)
				100–109	No function
				110–179	Lightning strobe, from low to high frequency (0–25 Hz)
				180–189	No function
13	20	Control Mode		190–255	Random strobe, from low to high frequency (0–25 Hz)
				000–010	No Function

8 CH (SSP)	13 CH (TOUR)	20 CH (TR16)	Function	Value	Setting
				011–100	Reserved
				101–110	Dimmer Off
				111–120	Dimmer Mode 4
				121–150	Reserved
				151–160	1200 Hz
				161–170	2400 Hz
				171–180	4000 Hz
				181–190	6000 Hz
				191–200	25000 Hz
				201–210	All Reset
				211–255	Reserved

Note: Make sure that the Master Dimmer channel is open to see the light output.

6.3.3. CMY (8 CH)

8 CH (CMY)	Function	Value	Setting
1	Master Dimmer	000–255	From low to high intensity (0–100 %)
2	Cyan	000–255	From low to high intensity (0–100 %)
3	Magenta	000–255	From low to high intensity (0–100 %)
4	Yellow	000–255	From low to high intensity (0–100 %)
5	Color Presets	000–010	No function
		011–015	Color 1 Loving Amber L176
		016–020	Color 2 Light Salmon R40
		021–025	Color 3 Scarlet L24
		026–030	Color 4 Flame Red L164
		031–035	Color 5 Easy White L747
		036–040	Color 6 Warm Peach R303
		041–045	Color 7 Dark Salmon L08
		046–050	Color 8 Sunset Red L25
		051–055	Color 9 Medium Bastard Amber L04
		056–060	Color 10 CID(To Tungsten) L237
		061–065	Color 11 Soft Golden Amber R321
		066–070	Color 12 Urban Sodium L652
		071–075	Color 13 LCT Yellow(Y1) L212
		076–080	Color 14 LEE Yellow L765
		081–085	Color 15 Ice And A Slice L513
		086–090	Color 16 Spring Yellow L100
		091–095	Color 17 LEE Plus Green L244
		096–100	Color 18 CalColor 30 Green R4430
		101–105	Color 19 Fern Green L122
		106–110	Color 20 Dark Yellow Green L90
		111–115	Color 21 LEE Fluorescent 3600 K L243
		116–120	Color 22 Turquoise R92
		121–125	Color 23 Kelly Green R94
		126–130	Color 24 Forest Green L327
		131–135	Color 25 Cosmetic Aqua Blue L191
		136–140	Color 26 Steel Green L728
		141–145	Color 27 Steel Blue L117
		146–150	Color 28 Special Steel Blue L354
		151–155	Color 29 Paler Lavender L53
		156–160	Color 30 New Colour Blue L501
		161–165	Color 31 Dark Steel Blue L174

8 CH (CMY)	Function	Value	Setting
		166–170	Color 32 Daylight Blue L165
		171–175	Color 33 Pale Lavender L136
		176–180	Color 34 Surprise Pink L194
		181–185	Color 35 Pale Violet L142
		186–190	Color 36 Perfect Lavender L700
		191–195	Color 37 Light Pink L35
		196–200	Color 38 Pretty'n Pink L794
		201–205	Color 39 Follies Pink L328
		206–210	Color 40 Magical Magenta L795
		211–215	Color 41 Pale Rose L154
		216–220	Color 42 Smokey Pink L127
		221–225	Color 43 Flesh Pink L192
		226–230	Color 44 Special Rose Pink L332
		231–235	Color 45 Moroccan Pink L790
		236–240	Color 46 Pink L157
		241–245	Color 47 Cherry Rose R332
		246–250	Color 48 Cool LED Bright Pink L128
		251–255	No function
6	CCT	000–009	No function
		010	1800 K
		011–025	1800–2200 K
		026–040	2200–2700 K
		041–055	2700–3000 K
		056–070	3000–3200 K
		071–085	3200–4000 K
		086–100	4000–4500 K
		101–115	4500–5000 K
		116–130	5000–5600 K
		131–145	5600–6000 K
		146–160	6000–6500 K
		161–175	6500–7000 K
		176–190	7000–8000 K
		191–205	8000–10000 K
		206–255	10000 K
9	Strobe	000–009	No function
		010–099	Strobe, from low to high frequency (0–25 Hz)
		100–109	No function
		110–179	Lightning strobe, from low to high frequency (0–25 Hz)
		180–189	No function
		190–255	Random strobe, from low to high frequency (0–25 Hz)
10	Dimmer Mode	000–010	No Function
		011–100	Reserved
		101–110	Dimmer Off
		111–120	Dimmer Mode 4
		121–150	Reserved
		151–160	1200 Hz
		161–170	2400 Hz
		171–180	4000 Hz
		181–190	6000 Hz
		191–200	25000 Hz
		201–210	All Reset
		211–255	Reserved

6.4. RDM Information

This device supports RDM. Refer to **6.4.2. Supported RDM PIDs for the Device** for more information.

6.4.1. RDM Details

- Responder ID: 29B4:0A1XXXXX
- Manufacturer's ID: Showtec (Highlite International B.V.)
- Manufacturer Label: Showtec
- Model Description: Performer Pendant 75 Q6
- Model ID: 161 (0A1 hexadecimal)
- Device Label: Performer Pendant 75 Q6

Note:

An RDM responder ID consists of 3 parts:

- 1st part – 4 digits – Manufacturer's ID
- 2nd part – 3 digits – Model ID
- 3rd part – 5 digits – Unique ID

The RDM responder IDs of all products of Highlite International start with the same 4 digits. The first 7 digits of the RDM responder ID for each model are the same. The last 5 digits are different for each device.

6.4.2. Supported RDM PIDs for the Device

Parameter ID	Value	Required	GET	SET
DISC_UNIQUE_BRANCH	0x0001	*		
DISC_MUTE	0x0002	*		
DISC_UN_MUTE	0x0003	*		
COMMS_STATUS	0x0015		*	*
STATUS_MESSAGES	0x0030		*	
STATUS_ID_DESCRIPTION	0x0031		*	
CLEAR_STATUS_ID	0x0032			*
SUPPORTED_PARAMETERS	0x0050	*	*	
DEVICE_INFO	0x0060	*	*	
DEVICE_MODEL_DESCRIPTION	0x0080		*	
MANUFACTURER_LABEL	0x0081		*	
DEVICE_LABEL	0x0082		*	*
FACTORY_DEFAULTS	0x0090		*	*
LANGUAGE_CAPABILITIES	0x00A0		*	
LANGUAGE	0x00B0		*	*
SOFTWARE_VERSION_LABEL	0x00C0	*	*	
DMX_PERSONALITY	0x00E0		*	*
DMX_PERSONALITY_DESCRIPTION	0x00E1		*	
DMX_START_ADDRESS	0x00F0	*	*	*
SLOT_INFO	0x0120		*	
SLOT_DESCRIPTION	0x0121		*	
SENSOR_DEFINITION	0x0200		*	
SENSOR_VALUE	0x0201		*	*
RECORD_SENSORS	0x0202			*
CURVE	0x0343		*	*
CURVE_DESCRIPTION	0x0344	*	*	
MODULATION_FREQUENCY	0x0347		*	*
MODULATION_FREQUENCY_DESCRIPTION	0x0348	*	*	
IDENTIFY_DEVICE	0x1000	*	*	*

7. Troubleshooting

This troubleshooting guide contains solutions to problems which can be carried out by an ordinary person. The device does not contain user-serviceable parts.

Unauthorized modifications to the device will render the warranty void. Such modifications may result in injuries and material damage.

Refer servicing to instructed or skilled persons. Contact your Highlite International dealer in case the solution is not described in the table.

Problem	Probable cause(s)	Solution
The device does not function at all	No power to the device	<ul style="list-style-type: none"> Check if power is switched on and cables are plugged in
	Main fuse is blown	<ul style="list-style-type: none"> Replace the fuse. See 8.3.1. Replacing the Fuse on page 31
The device does not respond to DMX control	The controller is not connected	<ul style="list-style-type: none"> Connect the controller
	The signal is reversed. The 5-pin DMX OUT of the controller does not match the DMX IN of the device	<ul style="list-style-type: none"> Install a phase-reversing cable between the controller and the device
	The controller is defective	<ul style="list-style-type: none"> Try using another controller
The device responds erratically to DMX control	Bad data link connection	<ul style="list-style-type: none"> Examine connections and cables. Correct poor connections. Repair or replace damaged cables
	The data link is not terminated with a 120 Ω termination plug	<ul style="list-style-type: none"> Insert a termination plug in the DMX OUT connector of the last device on the link
	Incorrect addressing	<ul style="list-style-type: none"> Check address settings and correct, if necessary
	In case of a setup with multiple devices, one of the devices is defective and disturbs data transmission on the link	<ul style="list-style-type: none"> To find out the defective device, bypass one device at a time until normal operation is restored
No light or LEDs cut out intermittently	LEDs are damaged	<ul style="list-style-type: none"> Disconnect the device and contact your Highlite International dealer
	The power supply settings do not match local AC voltage and frequency	<ul style="list-style-type: none"> Disconnect the device. Check the settings and correct, if necessary

8. Maintenance

8.1. Safety Instructions for Maintenance



DANGER
Electric shock caused by dangerous voltage inside

Disconnect power supply before servicing or cleaning.

8.2. Preventive Maintenance



Attention
Before each use, examine the device visually for any defects.

Make sure that:

- All screws used for installing the device or parts of the device are tightly fastened and are not corroded.
- The safety devices are not damaged.
- There are no deformations on housings, fixations and installation points.
- The lens is not cracked or damaged.
- The power cables are not damaged and do not show any material fatigue.

8.2.1. Basic Cleaning Instructions

The external lens of the device must be cleaned periodically in order to optimize the light output. The cleaning schedule depends on the conditions at the site where the device is installed. When smoke or fog machines are used at the site, the device will need more frequent cleaning. On the other hand, if the device is installed in well-ventilated area, it will need less frequent cleaning. To establish a cleaning schedule, examine the device at regular intervals during the first 100 hours of operation.

To clean the device, follow the steps below:

- 01) Disconnect the device from the electrical power supply.
- 02) Allow the device to cool down for at least 15 minutes.
- 03) Remove the dust collected on the external surface with dry compressed air and a soft brush.
- 04) Clean the lens with a damp cloth. Use a mild detergent solution.
- 05) Dry the lens carefully with a lint-free cloth.
- 06) Clean the DMX and other connections with a damp cloth.



Attention

- Do not immerse the device in liquid.
- Do not use alcohol or solvents.
- Make sure that the connections are fully dry before connecting the device to the power supply and to other devices.

8.3. Corrective Maintenance

The device does not contain user-serviceable parts. Do not open the device and do not modify the device.

Refer repairs and servicing to instructed or skilled persons. Contact your Highlite International dealer for more information.

8.3.1. Replacing the Fuse



DANGER
Electric shock caused by short-circuit

- Do not bypass the thermostatic switch or fuses.
- For replacement use fuses of the same type and rating only.

Power surges, short-circuit or incorrect electrical power supply may cause a fuse to burn out. If the fuse burns out, the device will not function anymore. If this happens, follow the steps below.

- 01) Disconnect the device from the electrical power supply.
- 02) Allow the device to cool down for at least 5 minutes.
- 03) Loosen the fuse cover with a screwdriver and remove the fuse holder.
- 04) If the fuse is brown or unclear, it is burned out. Remove the old fuse.
- 05) Insert a new fuse in the fuse holder. Make sure that the type and the rating of the replacement fuse are the same as the ones specified on the information label of the product.
- 06) Replace the fuse holder in the opening and tighten the fuse cover.

9. Deinstallation, Transportation and Storage

9.1. Instructions for Deinstallation



WARNING
Incorrect deinstallation can cause serious injuries and damage of property.

- Let the device cool down before dismounting.
- Disconnect power supply before deinstallation.
- Always observe the national and site-specific regulations during deinstallation and derigging of the device.
- Wear personal protective equipment in compliance with the national and site-specific regulations.

9.2. Instructions for Transportation

- Use the original packaging to transport the device, if possible.
- Always observe the handling instructions printed on the outer carton box, for example: "Handle with care", "This side up", "Fragile".

9.3. Storage

- Clean the device before storing. Follow the cleaning instructions in chapter **8.2.1. Basic Cleaning Instructions** on page 30.
- Store the device in the original packaging, if possible.

10. Disposal



Correct disposal of this product

Waste Electrical and Electronic Equipment

This symbol on the product, its packaging or documents indicates that the product shall not be treated as household waste. Dispose of this product by handing it to the respective collection point for recycling of electrical and electronic equipment. This is to avoid environmental damage or personal injury due to uncontrolled waste disposal. For more detailed information about recycling of this product contact the local authorities or the authorized dealer.

11. Approval



Check the respective product page on the website of Highlite International (www.highlite.com) for an available declaration of conformity.



©2022 Showtec